

From: **OWNER**  
Subject: **E01A-45111 (1037 Lakeshore Road E) -  
SMP2020 Compliance**  
Date: **Apr 25, 2021 at 7:29:18 PM**  
To: **Ian Woods ian@misterwaterfront.com**

---

From: SMP <[SMP@oro-medonte.ca](mailto:SMP@oro-medonte.ca)>  
Date: **November 24, 2020 at 11:42:00 AM EST**  
To: **OWNER**

**Subject: E01A-45111 (1037 Lakeshore Road  
E) - SMP2020 Compliance**

Re: **1037 Lakeshore Road E  
E01A-45111**

Good day,

Thanks for the email and document(s); the file has been updated and is now in compliance with the Septic Maintenance Program (SMP) for this 5-year cycle (2016-2020).

Your cooperation is appreciated and we will communicate again as the next cycle (2021-2025) commences.

Should you have any questions, please let us know.

Kind Regards,

# Septic/Holding Tank Pumper's Inspection Report

Property Owner: 111 S

Property MAS: 1037 LAKESHORE E ORO

Tank Type:  Septic Tank  Holding Tank

Tank Material:  Concrete  Plastic  Steel

Tank Size: ON FILE Litres

Outlet T in place  Yes  No

Effluent Filter:  Yes  No

Effluent Level:  Correct Height  Above Outlet  Below Outlet

Overall Tank Condition:  Good  Fair  Poor

Tank Lid Condition:  Good  Fair  Poor

Access Risers:  Yes  No

Location Sketch: ON FILE DOES NOT REQUIRE PUMPING.



Company (pumper): ORO SEPTIC

Name of Pumper: T McHARDY

Pump Date: INSPECT ONLY NOV 20- 2020

Note: This is a visual septic/holding tank inspection in conjunction with the provincially mandated on-site sewage system maintenance program.

LAKESHORE ROAD

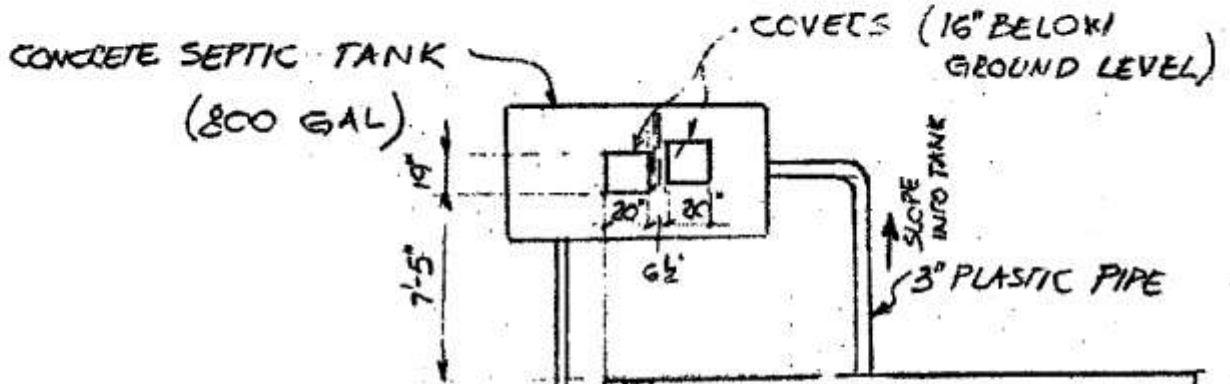

SEPTIC SYSTEM  
AT LOT 1037  
ORO-MEDONTE (LINE 9)  
(INSTALLED AUG 1983)  
(BY LLOYD SQUIRE)

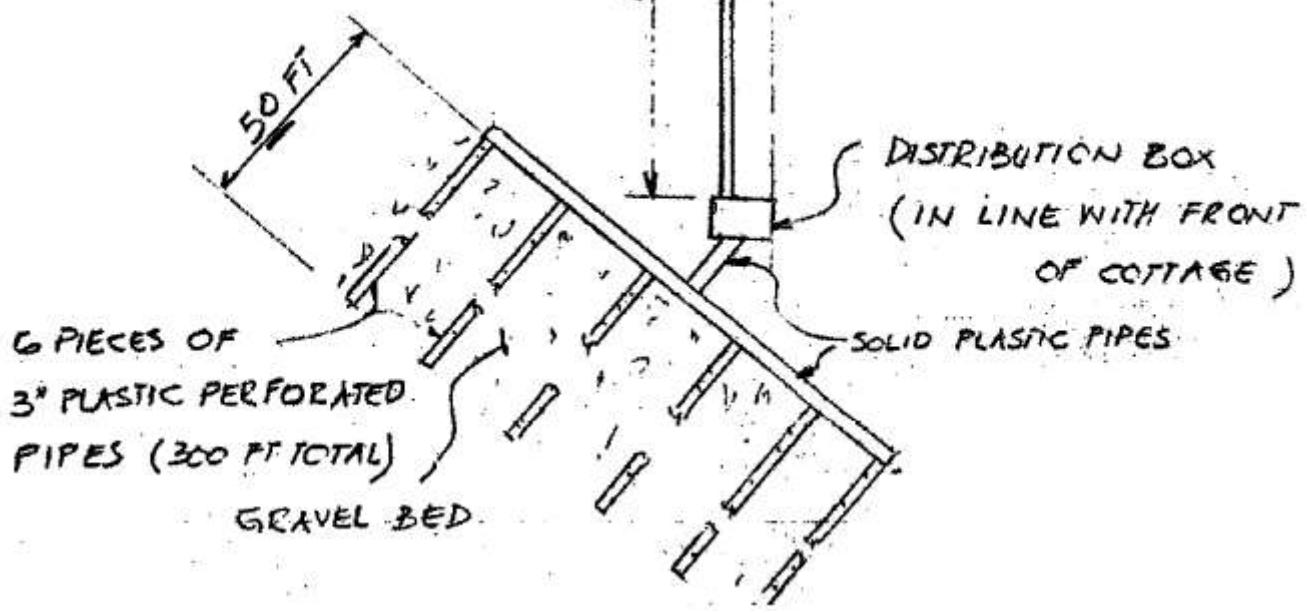
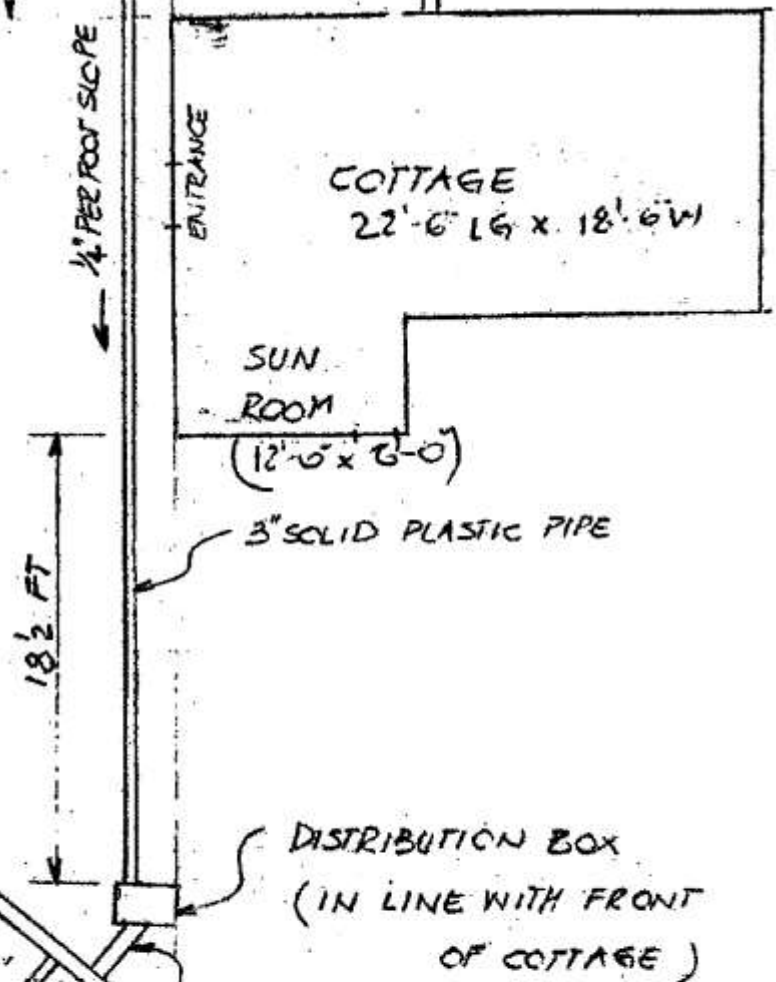

# Simcoe County District Health Unit

## SEWAGE SYSTEM INSPECTION FORM

July 12, 1972

File # 082

TWP. OF ORO

DATE

MUNICIPALITY

LOT CON. 9 PLAN 863 LOT 28 BUILDING: Frame bungalow

OWNER: Mr. H. Kriesmayer,  
3 1/2 Rexford Rd.,  
ADDRESS: Toronto 326, Ont..

NO. OF BEDROOMS: 2

FIXTURES: 3-piece bath .....  
2-piece bath ..... 1 .....  
Kitchen sink ..... 1 .....  
Laundry tubs .....  
Automatic laundry .....  
Other .....

CONTRACTOR: Lloyd Squire

ADDRESS: Shanty Bay

LIQUID CAPACITY OF SEPTIC TANK: 800	CONSTRUCTION: Prefab <input checked="" type="checkbox"/> Other .....
TOTAL FT. OF TILE BED: 300	TYPE OF SOIL: Medium loam
LEADER: 3" plastic - sealed joints - to & from distribution box	HEADER: 3" plastic - sealed joints
LATERALS: 3" plastic - perforated - laid in 18" trenches over 6" of 1/4" crushed stone proper grade - capped ends	
WATER SUPPLY: Type of Well Lake supply Distance from bed 100' Municipal	
COMMENTS: The outlet from distribution box servicing laterals nearest the lake approx 2' lower than these nearest house due to slope in ground - Not connected to drain	

time of inspection.

Satisfactory

ROUGH SKETCH SHOWING DESIGN AND LOCATION

K O A D

<p>APPROVED</p> <p>AT TIME OF INSPECTION</p> <p>M.O.H. DR. N. ARMBRUST</p> <p>Per <i>[Signature]</i></p> <p>C.P.H.I.(C)</p>
---

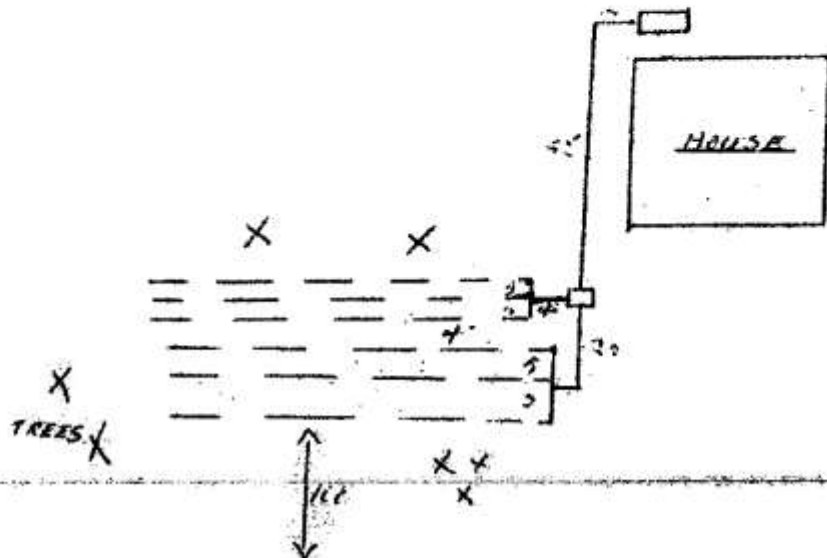

# Simcoe County District Health Unit

76 Mississauga St.W.,  
Orillia, Ontario.  
August 11, 1971.

Mr. H. Kriesmayer,  
34 Rexford Rd.,  
Toronto 326, Ontario.

C. Oro Township

Dear Sir:-

Re: Proposed Sewage Disposal System

Your notification of a proposed sewage disposal system at Oro Township

Lot 28, Con.9, Pl.863 <sup>28</sup> Lot has been received. We consider the above-mentioned lot suitable for a sewage disposal system to serve a dwelling of 2 bedrooms. The sewage disposal system will consist of a concrete septic tank of 600 gallons, and 300 feet of weeping tile, laid in a minimum of 13 inches of crushed stone (approximately 5 inches under the tile and 3 inches over) in an 18 inch wide trench. Approximately 27 tons of crushed stone will be required.

Before approval can be issued, it will be necessary for the system to be inspected before covering, and at least 24 hours notice must be given to the above office.

Should the system be covered without inspection, it will be necessary for the entire system to be exposed. Failure to comply may result in proceedings being taken under Section 14 of Schedule B of the Public Health Act.

If system placed between house and roadway, the building will need to be raised to a height of approx. 2', that will permit gravity flow to septic system. Recommend system be placed at side or in front of house and run toward lake, keeping Min. of 50' from lake with laterals.

Yours truly,

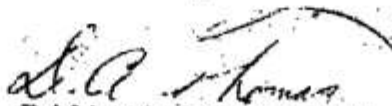
  
Public Health Inspector  
D.A. Thomas, C.P.H.I. (C)

sc

9/11/71 HOLDING TAXER

# KNELSEN WATER WELLS

FAST, EFFICIENT SERVICE

AUGUST 6, 1978

NAME H. KRISMAKER

ADDRESS E. ELFORD BAUD <sup>TOR</sup> 1127 <sup>224</sup>

156'	6" DRILLED WELL		
	(2) 15.00 PER FOOT	2.375	MO
1	WELL SEAL N.C.		
1	DRILL SHOE N.C.		
<i>Drilled by H.B. Lip</i> <i>with 1 1/2" bit</i> <i>by Knelsen</i>			
		TAX	

2032

LAWSON & JONES LTD., LONDON, ONT.

- 100' @ 40.50'

- Max. 40 PSI now